

Compact External Fitting with 1/2" Taper Thread SSF212

The SSF212 series is a horizontally mounted switch that is mounted externally in the side of the tank, with a 1/2" NPT (fits 1/2" BSP) thread.

They are manufactured in 304 grade Stainless Steel, for those liquids and environments that require the use of Stainless Steel and will work in liquids of SG 0.8 minimum.

The switch action may be reversed by mounting the device with the orientation arrow pointing downwards, instead of the normal upwards direction.

A version is available, Type SSF212XP, with a plug and socket, for customer wiring.

- Stainless steel
- External mounting
- Compact design
- Temperature range to 120°C
- User configurable N/O or N/C action

| Technical specifications | | | |
|--------------------------|-----------|----------------------------------|-----------------|
| Mounting style | External | Cable length - standard | 500mm |
| Mounting thread | 1/2" NPT | Cable size | 17/0.10 - AWG22 |
| Float & Stem material | 304 grade | Cable conductor material | Tinned copper |
| Maximum Temperature | 120°C | Cable sheath material | XLPE |
| Maximum Pressure | 5 bar | Cable temperature rating | 125°C |
| Float SG | 0.7 | Sealing gasket | Not supplied |
| Minimum fluid SG | 0.8 | Tightening torque for fixing nut | N/A |

| Electrical specifications | |
|---------------------------|-----|
| Contact type | N/O |
| Switching Power Max. VA | 50 |
| Switching Current Max. A | 0.5 |
| Switching Voltage AC | 300 |
| Switching Voltage DC | 300 |

All ratings are for resistive load only

| Standard Parts | Leadouts |
|----------------|----------------------------|
| SSF212X050 | 50cm XLPE wires |
| SSF212XP | Plug and socket connection |

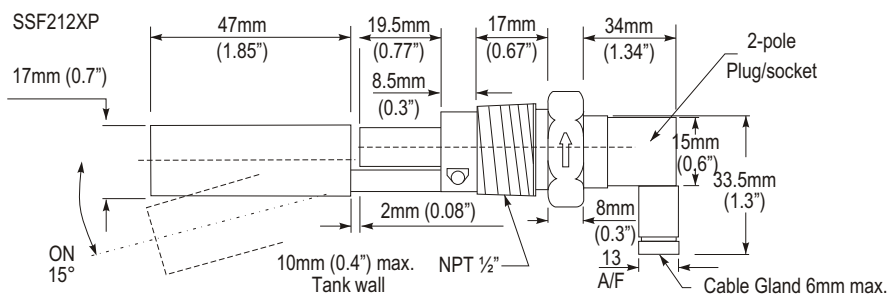
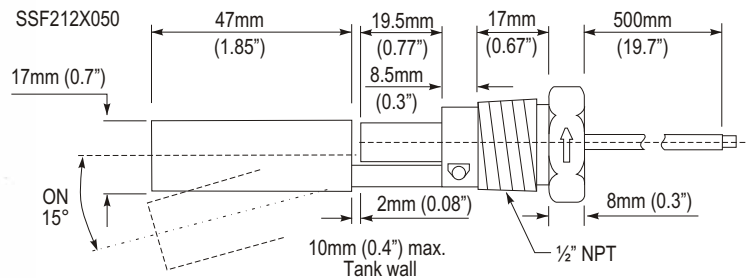

Outline dimensions